

FENIX MISTRAL

Aero front end

Pre- thread the M33-16-F Sphere ball joint using the Titanium TR15-M4.

You might want to use some light oil during this operation.

Prepare 2 groups as show

Separate the 2 "aero arms" and shave the burrs.

Insert 2 M3x15 HW0038 as shown.

Take your time and take care not to thread them with a different angle.

Make 2 sets

Leave 5mm of thread exposed and install the ball cup FX0150-S

Thread them completely, do not leave exposed threads.

Both ball cup **must** be parallel between them and parallel to the upper face of the arm.

Shiny face **must** be oriented to the lower face

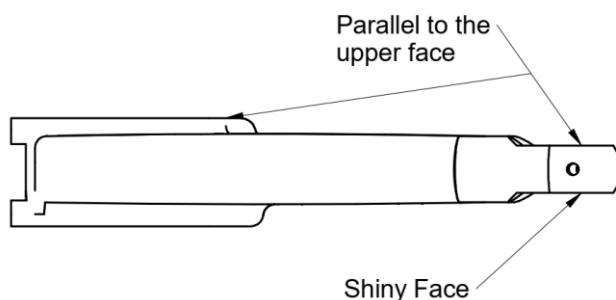
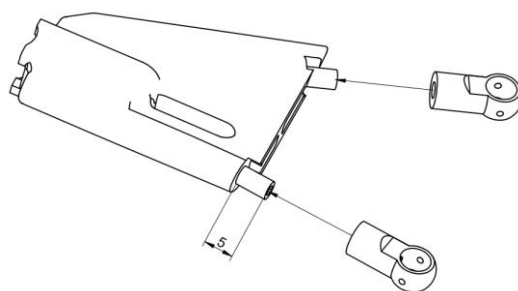
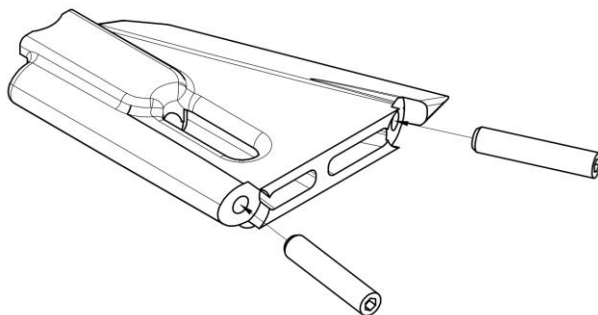
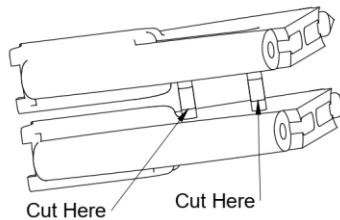
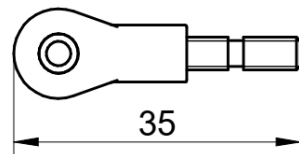
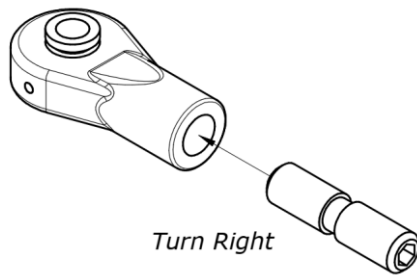

Aero front end

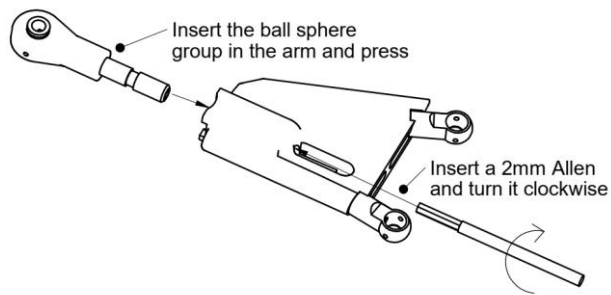

Insert the the ball sphere group into the aero-arm
Keep the shiny face parallel to the lower side of the aero-arm

Turn the 2mm Allen key **clockwise**

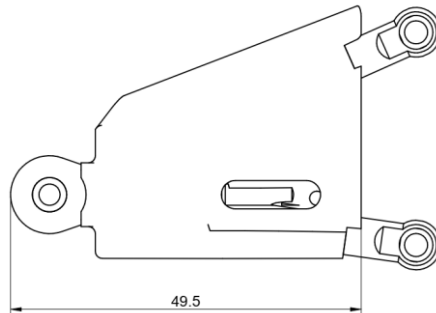

Set the dimension as shown. Make 2 sets.

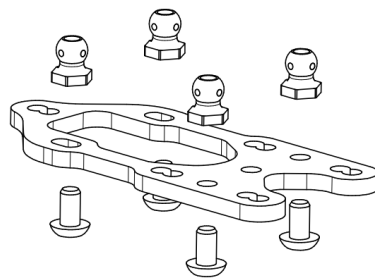

Fix 4 Fx0061 female balls using 4 x M3x6 HW008.

Note: Tight firmly only the front ones. Set the rear ones hand tight only.

Note: Box plate allow you to set the caster at 6° or 12°. Different caster arms are available as option parts.

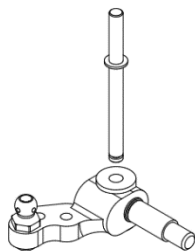

Insert the kingpin into the steering hub

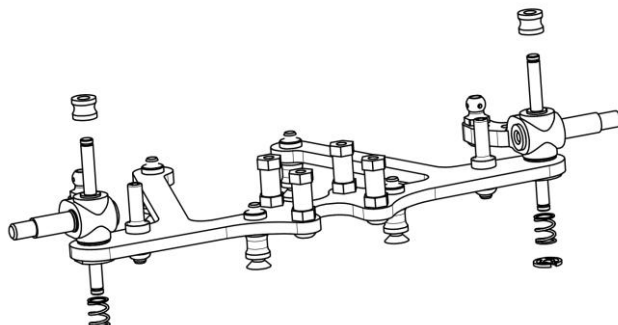

Insert springs on the kingpin and secure them with the seeger.

Slide the 2 x 5mm shims over the kingpin

Aero front end

Fix the caster plate M39-M-6-12 using 4 M3x8 button screw.

The 2mm shims are used to adjust the front end roll center.

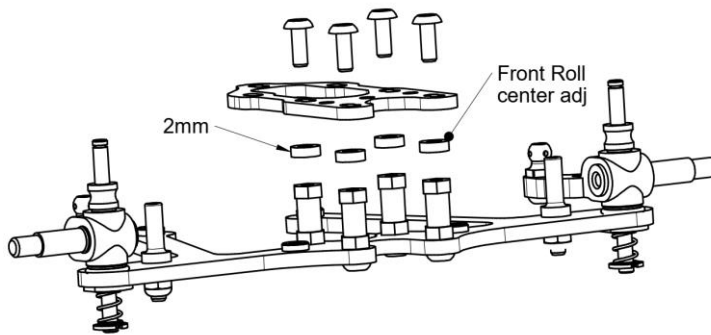

Note: Some parts omitted for sake of clarity.

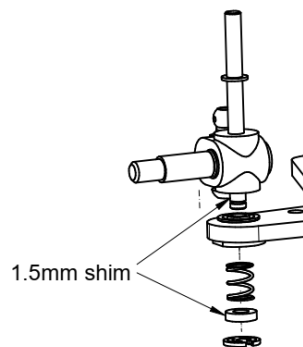

Note: Ride Height

You can alter the ride height of the car, moving the provided 1.5mm shim.

Pic show the 2 potential location.

While we're in "spring" area... Remember that front soft springs are getting weaker after few runs. Check them often!

Shimming under the steering knuckle will reduce the suspension travel. Shimming under the spring, allow you to fine tuning the spring preload

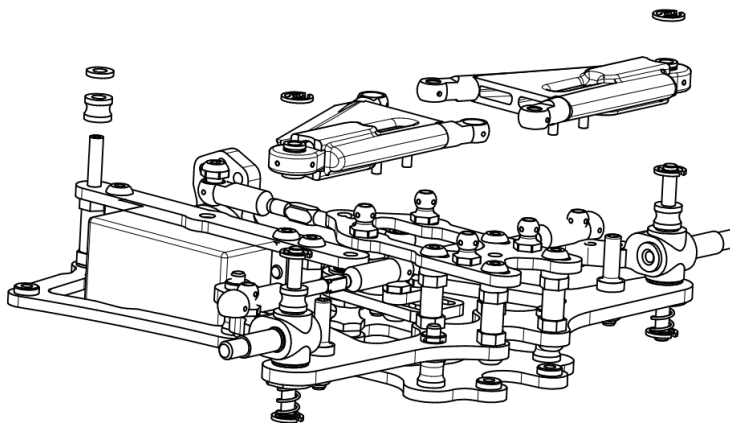

Insert the aero-arms over the female balls and over the kingpin. Secure the position using 2 seeger

Slide 1 x 5mm + 1 x 1mm shims over the HW0039

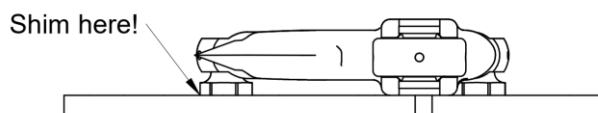

Dynamic Caster

If you want to play with caster dynamic angle, just add 1 – 2mm shims here. Check always that the aero-arms are moving freely.

Aero front end

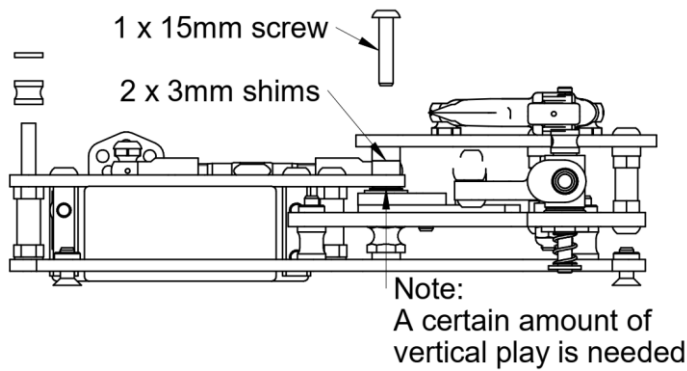

Use one HW030 M3x16 button screw to fix the steering post.

Use 2 x 3mm shims between the caster plate and the servo plate.

If you change the shims to adjust the roll centre, you've to adjust those shims as well.

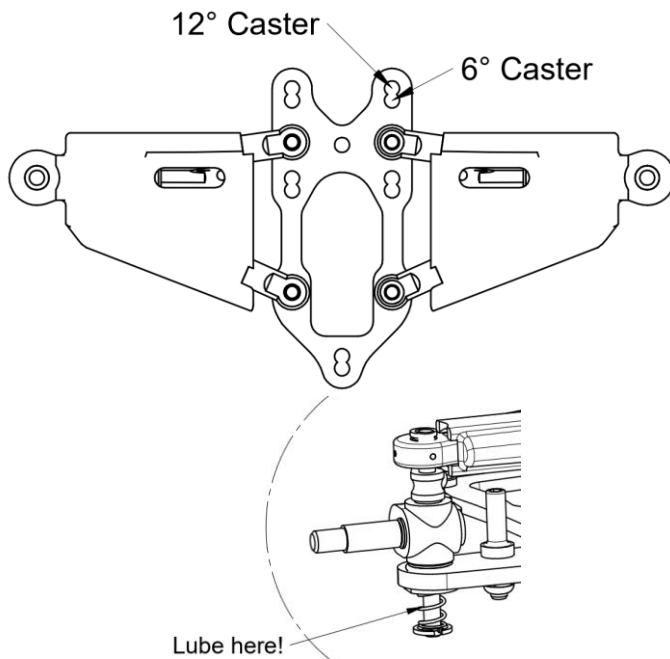

Start with 6° degree position, you'll discover it's a very good "all around"

Racing tip:

A good starting point is #5000