

***FENIX** Classique*

Team Lotus type 49

Body instruction Manual Rev. 0.1

July 2019

Approved and licensed by Classic Team Lotus Ltd
www.classicteamlotus.co.uk



Please note. *Classique* is not the usual rc model car. The assembly procedure, although very simple, is a little unusual, being the body “part” of the car.

So, please, read the manual before start the assembly. Body should be painted before the installation.

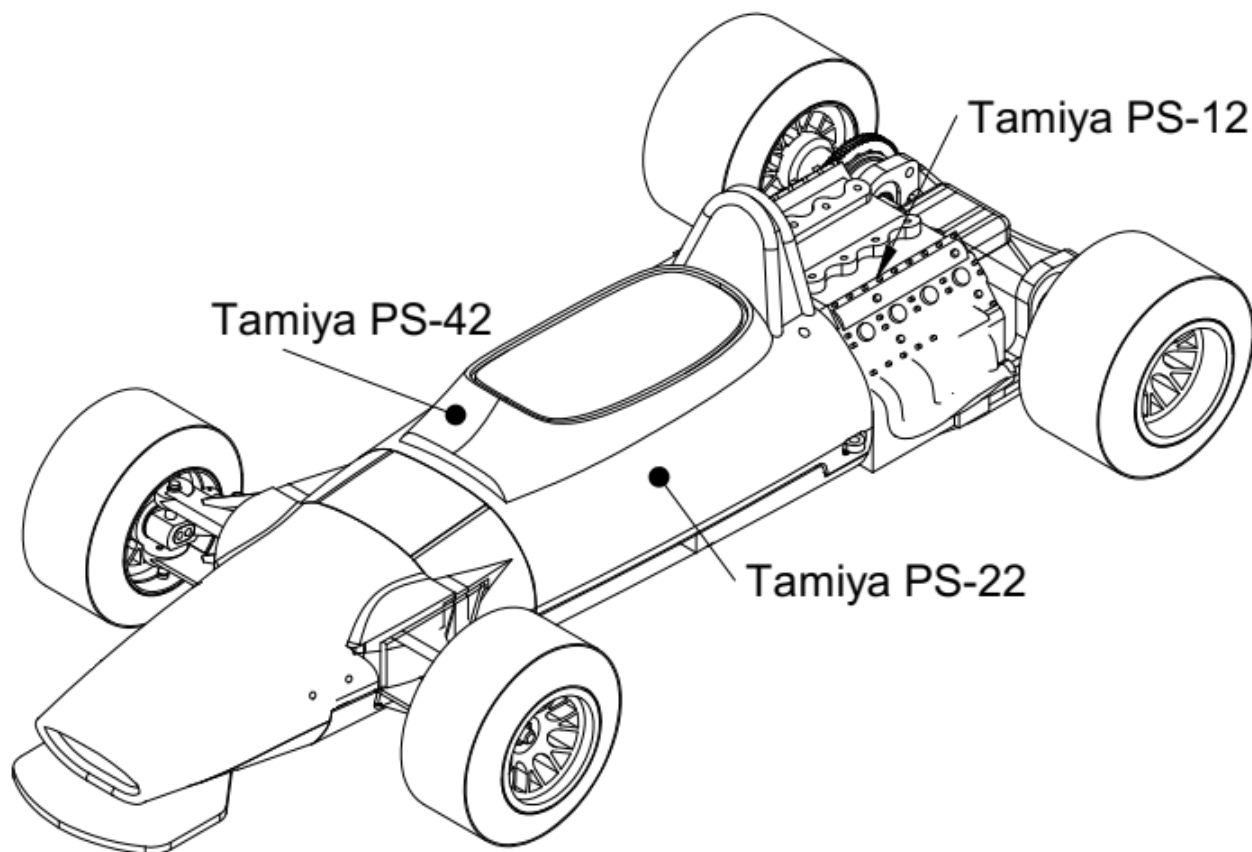

Best solution for painting the Classic Team Lotus 49, is rely over Lexan Tamiya PS- colours. As usual, wash the body with warm water, using a drop of dish soap.

Remind to paint darker colours first, and clear colours later. Best is start with the chassis area. A good masking tape like Tamiya 87034 will help you.

The iconic yellow stripe is provided in the decal sheet, so you can just paint the body using the Tamiya PS22 Racing green. Remember to mask the body cowl, later you can choose to leave it clear or paint it with a transparent yellow such as the Tamiya PS42.



1967 Dutch GP
5 J. Clark
6 G. Hill

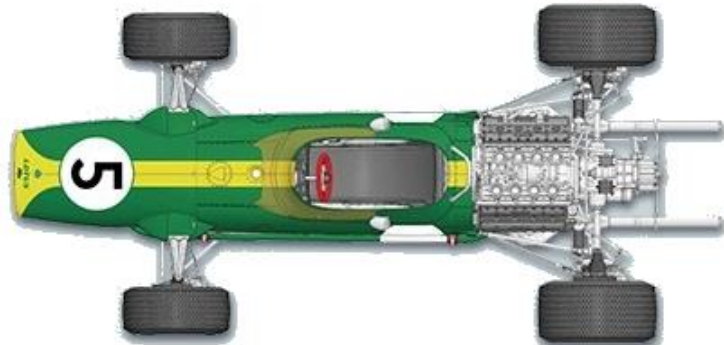

1967 German GP
3 J. Clark
4 G. Hill

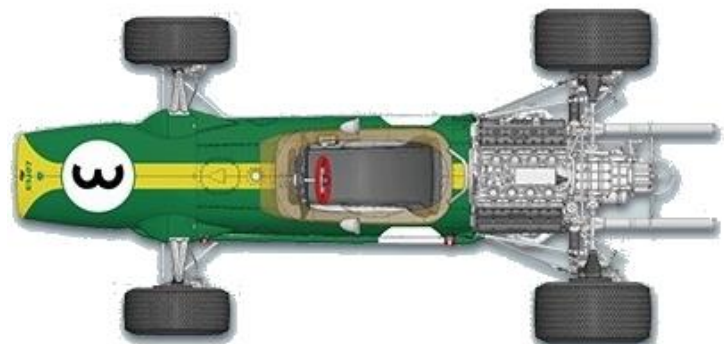

1968 South African GP
3 J. Clark
4 G. Hill

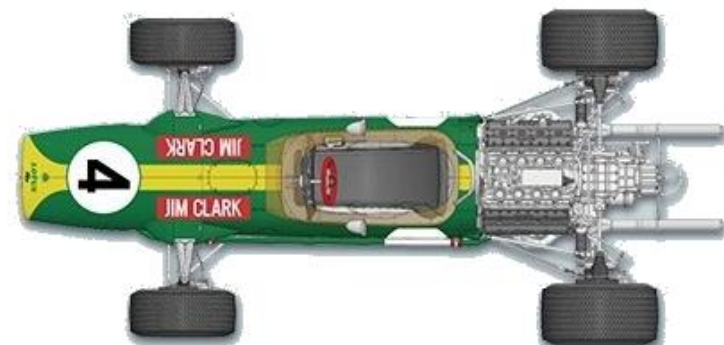

Lower body preparation

Let's start with
lower part of the
body

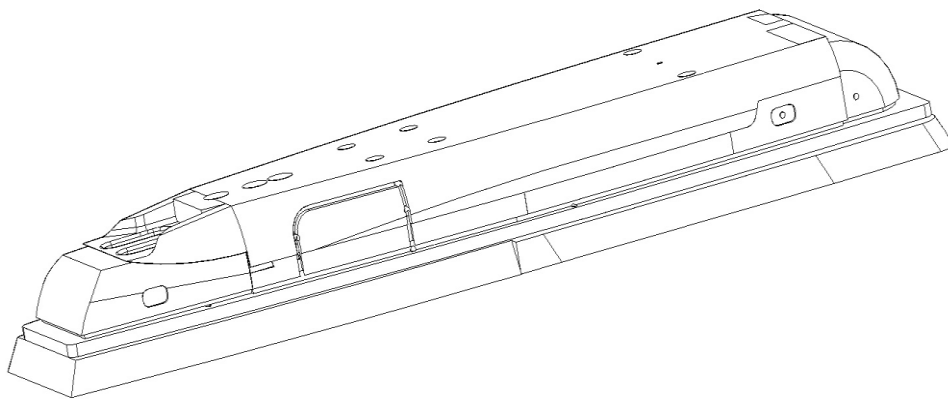

Cut as shown –
Open the grey
holes

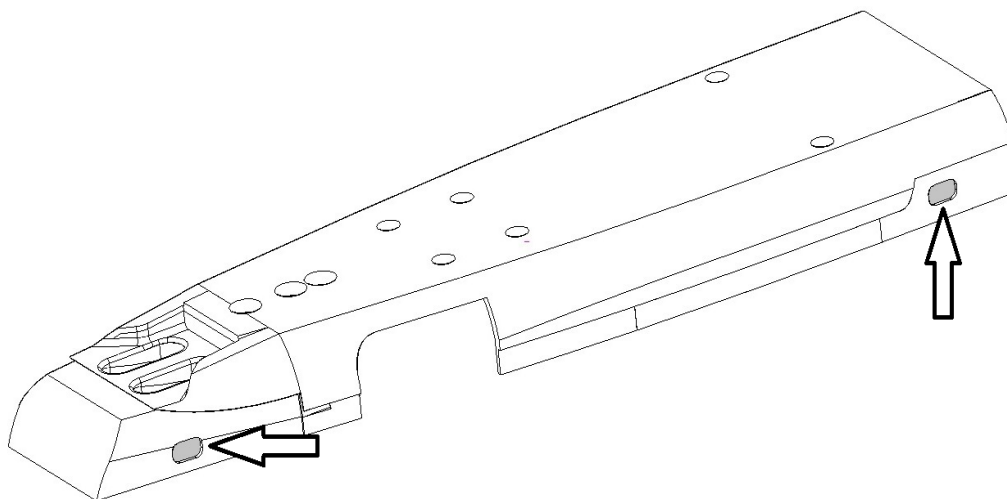

Drill the grey
holes - Open the
grey area

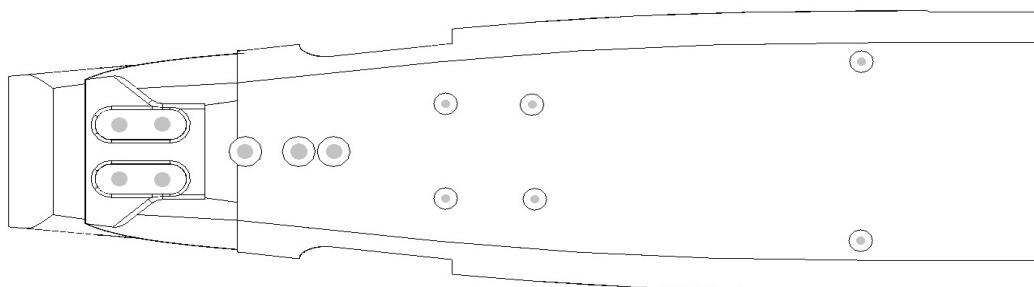

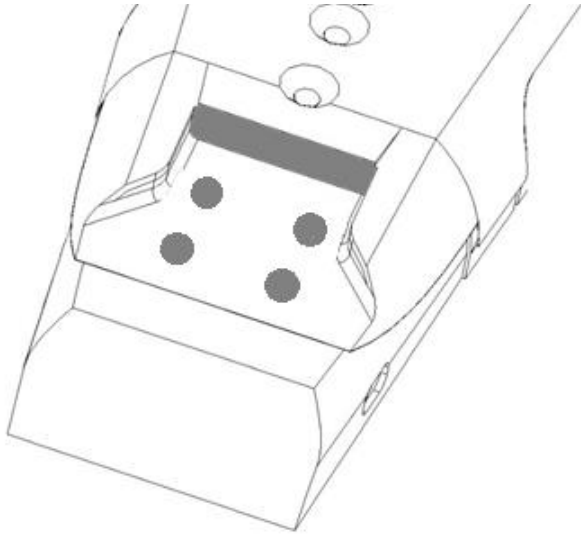

Open the grey rectangle.
You might want to paint the lower body in this moment.

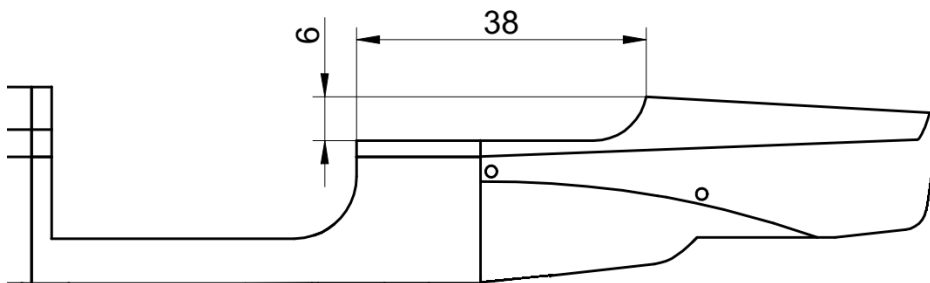

Cut a portion of the lower body as shown.

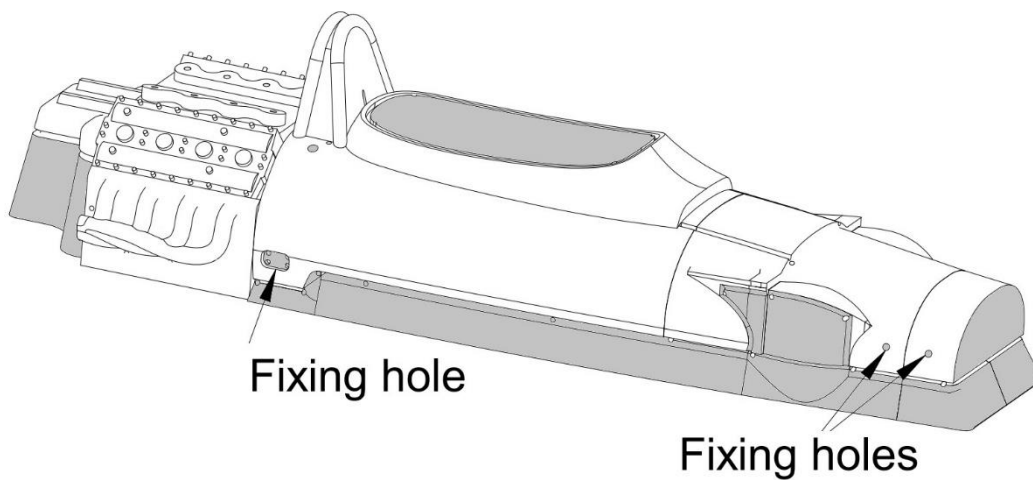

Cut the upper part of the body as show. Open the side grey holes and front ones. Front ones should be about $\varnothing 3\text{mm}$. Take care that the grey hole will be used to fix the body to the model

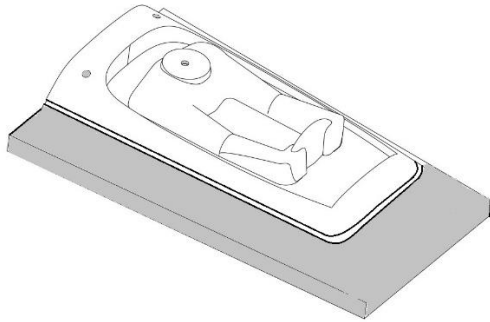

Paint and fix the driver head to the driver body and cut the grey area.
Drill the grey holes \varnothing 3mm

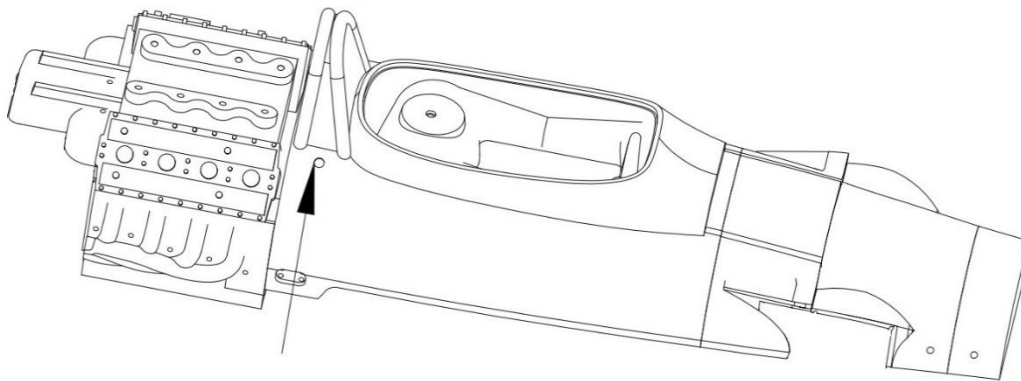

Fix the driver body to the upper body. Use the provided M3x6 button screws and nuts.

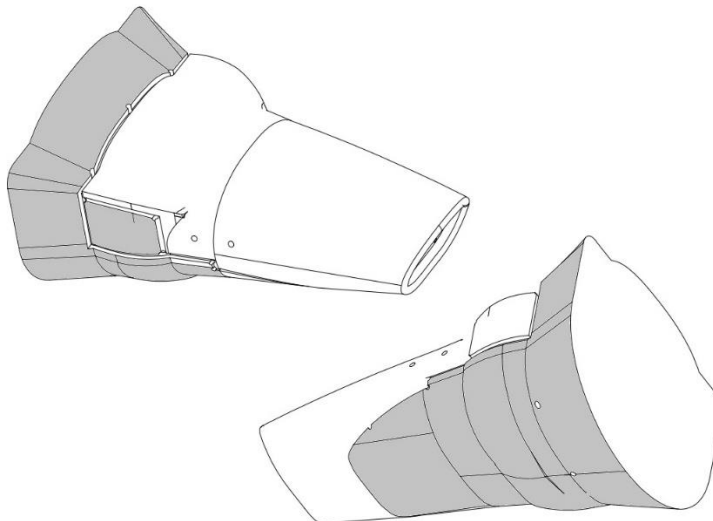

Cut the nosecone as show

Using the dimples as reference drill 4 by \varnothing 3mm

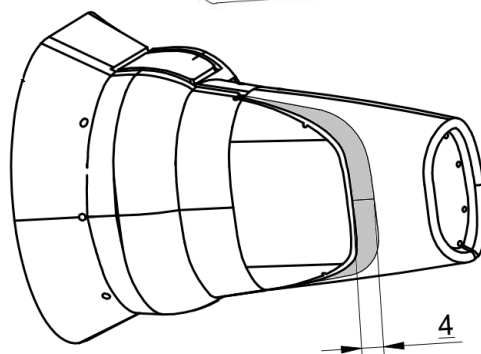

Note:

For easy fit, you may need to cut the nose cone about 4 mm more

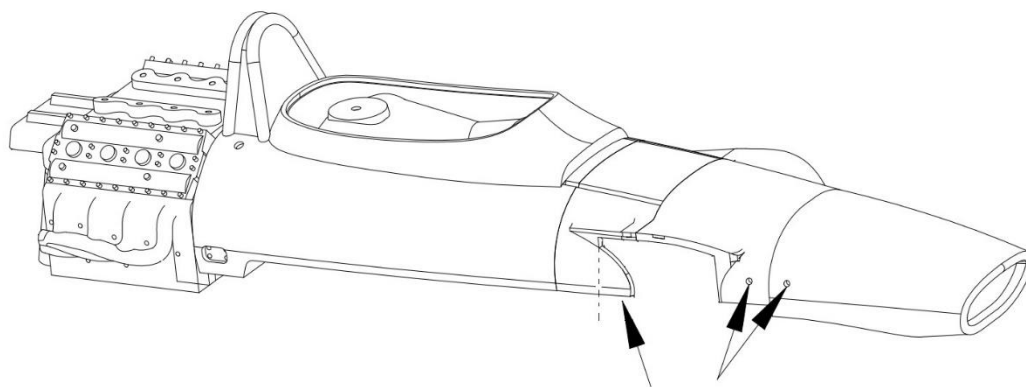

Fixing the nose cone.

Using 4 by M3x6 button screw, fix the nose cone to the upper body.

Note:

For an easier fit, you may want to cut the body along the dotted line.

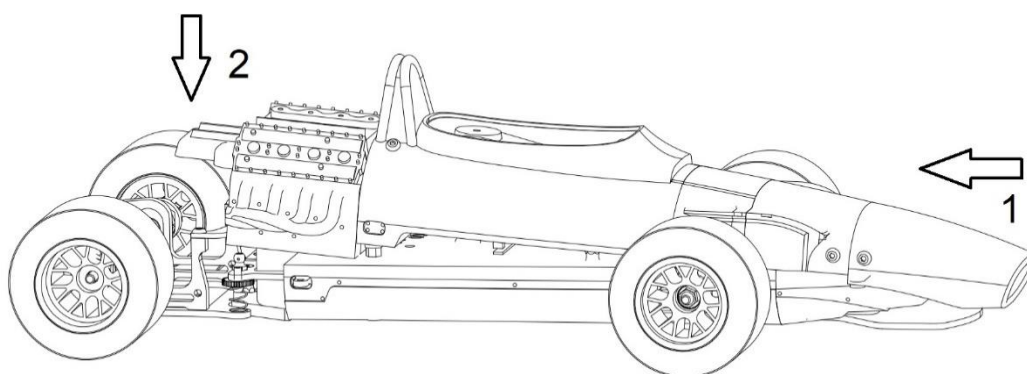

1 - Slide the upper body over the lower body

2 - rotate it.

Slide over the fixing points and secure it using 2 fixing clips

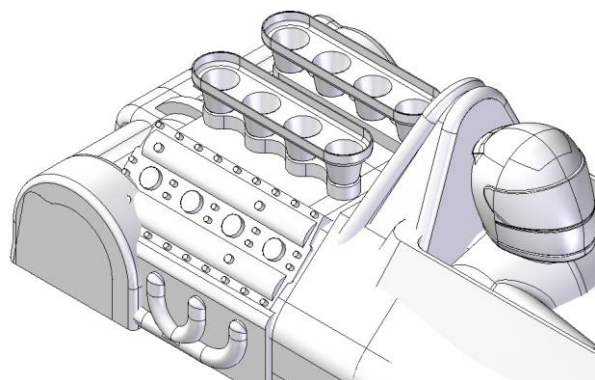

Fix the driver helmet to the upper body

Fix the inlet stacks to the motor.